

KVRI 5025 EC 30

131434

- Backward curved radial impeller
- Swing out fan unit
- Galvanized sheet steel housing, double-walled, 25 mm mineral wool
- High efficiency EC motor, steplessly controllable
- Conveyed medium temperature up to 60 °C in continuous operation



MAP

Name	Value	Unit
Volume flow	0	m ³ /h
Pressure	0	Pa

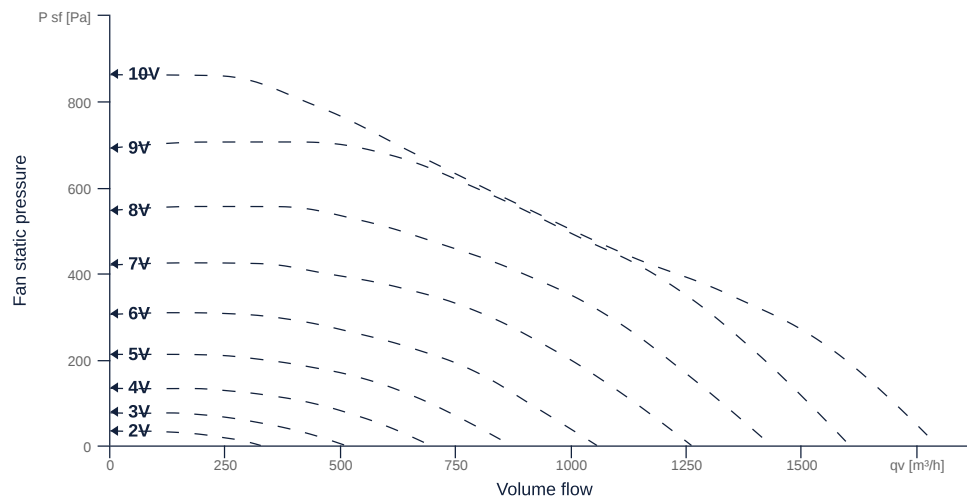

zur Produktseite

KVRI 5025 EC 30

131434

ruck

GENERAL DATA

Name	Value	Unit	Formula symbol
ERP conformity	Yes		
Certifications	CE, UKCA		
Duct size	500x250		WxH _{duct}
Pipe connection size (DN)	-		DN
Rated voltage (entire device)	230	V	U _{rated}
Phases (entire device)	1~		phase
Electrical protection (entire device)	6 A		fuse
Housing material	Galvanized steel		mat _{casing}
Impeller material	Galvanized steel		mat _{impeller}
IP-protection class (entire device)	IPX4		IP _{compl}
IP-Protection class (terminal box)	IP44		IP _{ebox}
Weight	21.1	kg	m
Nominal air flow rate, nominal point m ³ /h	741.6	m ³ /h	q _{v,nom}
Nominal external pressure, static	334.9	Pa	p _{s,nom}
Fan type	Radial		Fan _{type}
Category / Installation situation	A		cat

ERP DATA (LOT 6)

Name	Value	Unit	Formula symbol
Nominal air flow rate, nominal point m ³ /s	0.21	m ³ /s	q _{v,nom}
Actual electrical input power, nominal point	0.12	kW	Pe <sub,nom< sub=""></sub,nom<>
Face velocity, nominal point	1.6	m/s	v _{nom}
Nominal external pressure, static	334.9	Pa	p _{s,nom}
supply air fan static efficiency, nominal point	58.7	%	η _{es,SUP}
Enclosure sound level, nominal point	70	dB(A)	L _{WA2}
Rating	Product is compliant 2018		

zur Produktseite



KVRI 5025 EC 30

131434

ruck

MAXIMAL DATA

Name	Value		Unit	Formula symbol
	50 Hz	60 Hz		
Max. power consumption (device)	268	268	W	$P_{ed, max}$
Max. operating current (device)	1.89	1.89	A	$I_{ed, max}$
Max. speed	2960	2960	1/min	n_{max}
Max. stat. efficiency	49.5	49.5	%	η_{es}
Max. fan efficiency	49.8	49.8	%	η_e
Max. flowrate	1790	1790	m ³ /h	Q_v, max
Max. stat pressure	860	860	Pa	$p_{st, max}$
Max. medium temperature	55	55	°C	T_m, max
Max. environment temperature	55	55	°C	$T_{amb, max}$
Min. environment temperature	-30	-30	°C	$T_{amb, min}$



zur Produktseite

KVRI 5025 EC 30

131434

SCHALTPLÄNE / MASSZEICHNUNGEN

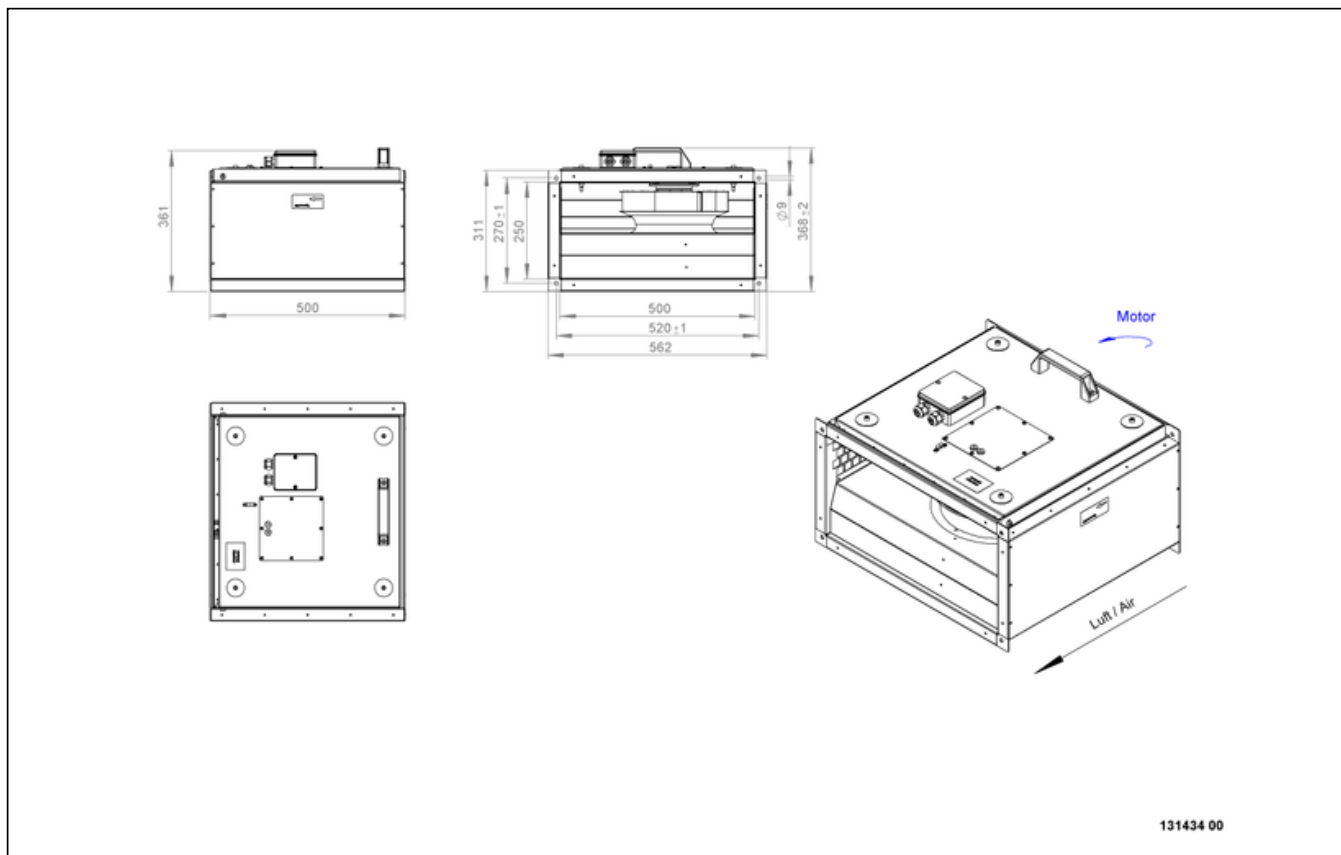



zur Produktseite

KVRI 5025 EC 30

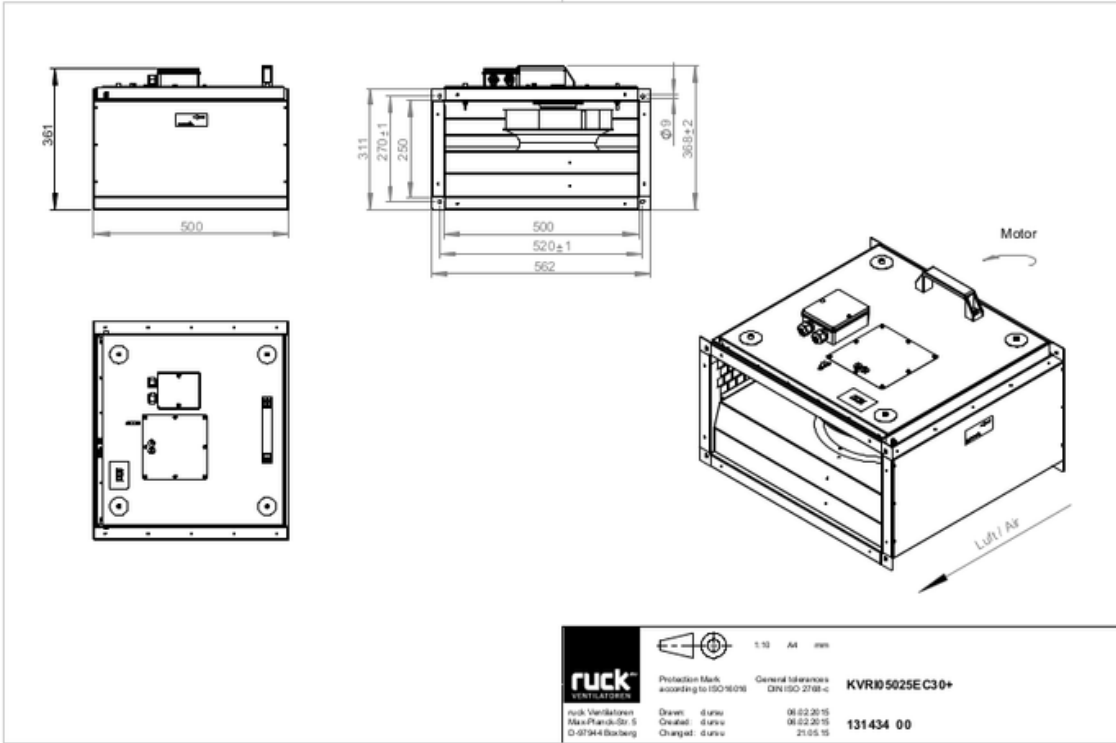
131434



		1:10 A4 mm		
	Protection Mark according to ISO 9006	General tolerances DIN ISO 2768-c	KVRI 5025 EC 30+	
	ruck Ventilatoren Max-Planck-Str. 5 D-97944 Boxberg	Drawn: d.urs Created: d.urs Changed: d.urs	08.02.2015 08.02.2015 21.05.15	131434 00



zur Produktseite

KVRI 5025 EC 30

131434

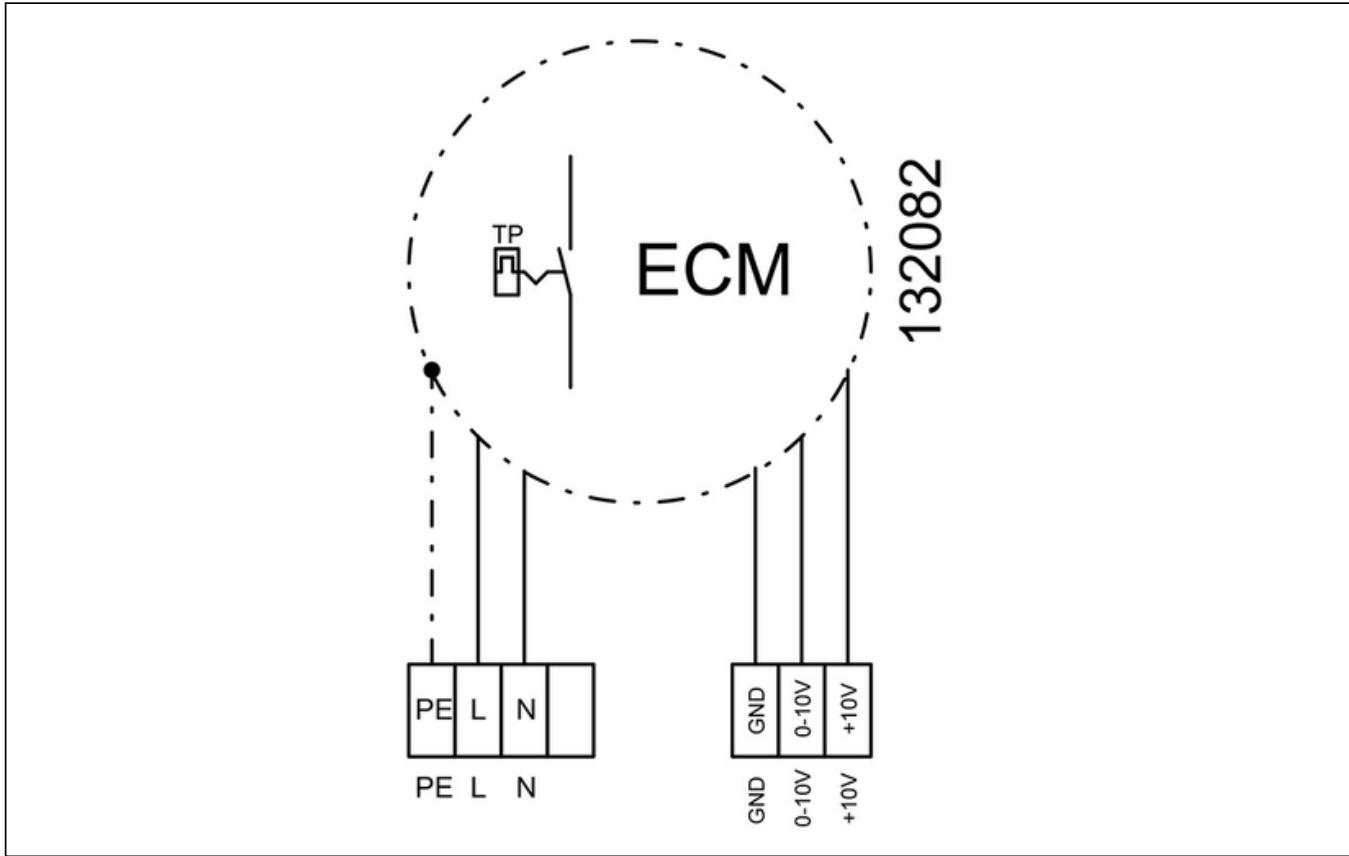

zur Produktseite

KVRI 5025 EC 30

131434

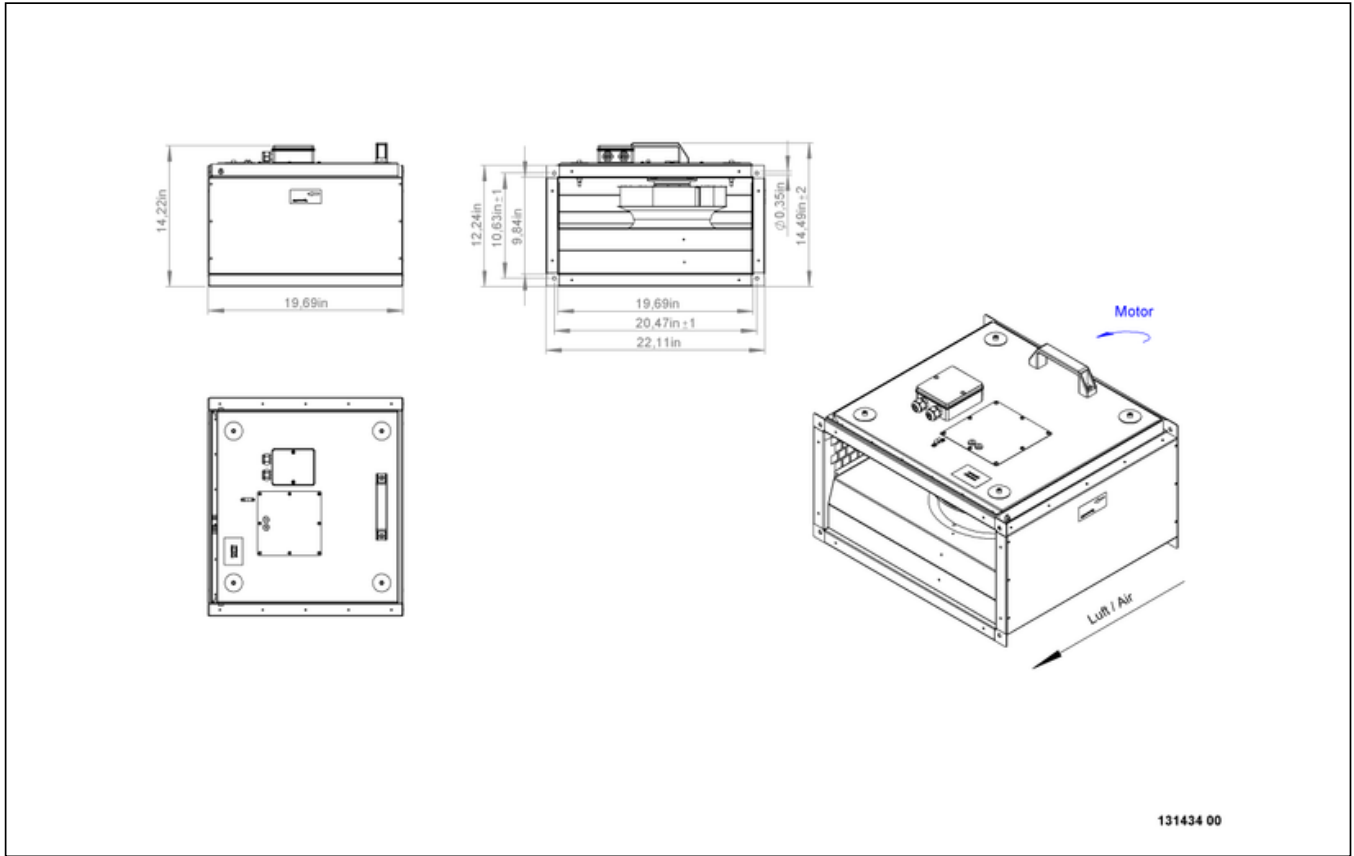

zur Produktseite

KVRI 5025 EC 30

131434

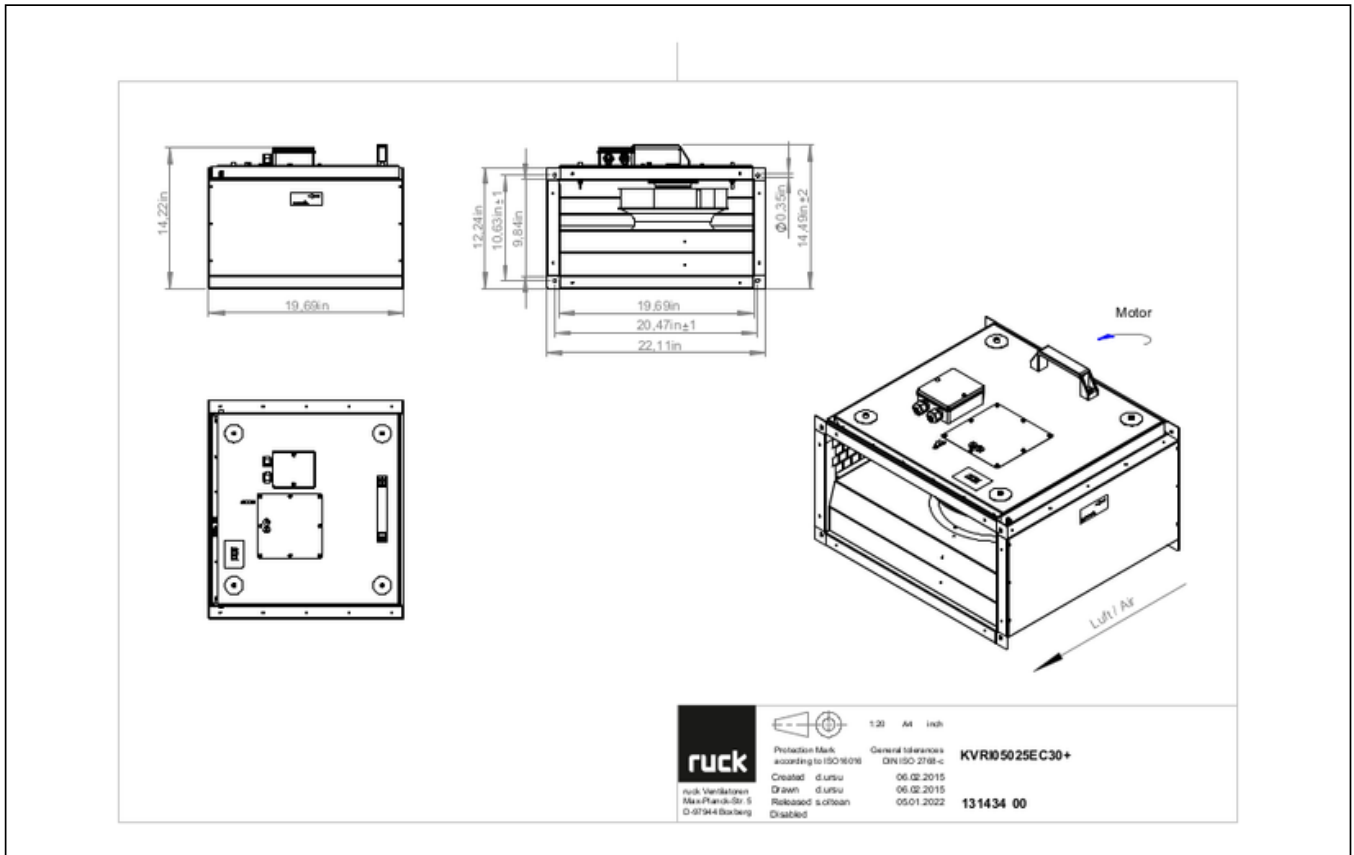

MECHANICAL ACCESSORIES

VS 5025 | 102804



- Duct connector, flexible
- Standard profile flange P20
- Galvanized steel sheet, plastic band (PVC)
- Temperature resistant up to 70 °C

VKK 5025 | 103894



- Automatic shutter
- Plastic, weather resistant
- Temperature resistant up to 70 °C



KVRI 5025 EC 30

131434

ELECTRICAL ACCESSORIES

GS 03 | 107633



- Device switch
- $U_{max} = 400\text{ V}$, $I_{max} = 25\text{ A}$
- Switching capacity $400\text{ V } 3\text{-} = 5,5\text{ kW}$
- Protection class IP 55

CON P1000 | 115259



- Constant pressure control
- Actual value display possible via optional control unit
- Output 0-10 V DC + FC enable + setpoint reached
- Pressure setting by means of decade switch

MTP 20 | 128146



- Potentiometer 10 k Ω
- Switching contact 1A/250V AC - 2,5A/12V DC
- Max. ambient temperature 50 °C
- VDE

MTP 30 | 143289



- Stepped potentiometer 10 k Ω
- Step 1 + 2 settable 10 % - 100 % Vdc
- Step 3 100 % Vdc
- Supply voltage +10 Vdc

MTP 40 | 147359



- Potentiometer 10 k Ω
- Connection in terminal box
- Max. ambient temperature 50 °C
- PU: 20 pieces

MTP 50 | 153133



- Potentiometer with multifunction output
- 230 VAC $\pm 10\%$ / 50-60 Hz
- Selectable output: 1-10 VDC / 2-20 mA / 10-100 % PWM
- Min. and max. output value adjustable



zur Produktseite