

# Technical Data Sheet

CODE 15000

## TIRACAMINO TC 10 M

Radial chimney fan



### Certifications



### TECHNICAL AND PERFORMANCE DATA

Absorbed Current max (A)	0,5	Delivery max (m <sup>3</sup> /h)	750
Absorbed Power max (W)	120	Portata max 60Hz (l/s)	252
Frequency (Hz)	50-60	Portata max 60Hz (m <sup>3</sup> /h)	910
Insulation Class	I <sup>o</sup>	Pressure max (mmH <sub>2</sub> O)	19
IP	X4	Pressure max (Pa)	186
Max absorbed Power at 60Hz (W)	150	Pressure max 60Hz (mmH <sub>2</sub> O)	26
Nominal Diameter (mm)	180	Pressure max 60Hz (Pa)	255
Voltage (V)	220-240	RPM	1400
Weight (Kg)	14,3	RPM max	1400
Delivery max (l/s)	208	Sound Pressure level Lp [dB (A)] 3m	52

### DIMENSIONS

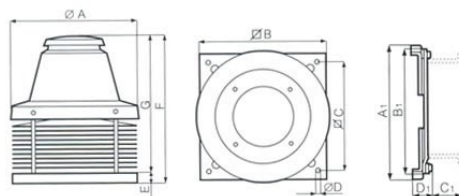

Size A (mm)	Ø
	405 -
	A1
	401
Size B (mm)	410 -
	B1
	357
Size C (mm)	357 -
	C1
	140
Size D (mm)	Ø 10
	- D1
	40
Size E (mm)	38
Size F (mm)	518
Size G (mm)	480

#### PER INFORMAZIONI:

Servizio al Cliente: tel +39 02 90699395 premendo 1 dopo messaggio registrato (consulenza su prodotti e impianti)

Pre & Post Vendita: fax +39 02 90699302

Email prevendita: prevendita@vortice-italy.com

# Technical Data Sheet

CODE 15000

## TIRACAMINO TC 10 M

Radial chimney fan



### DESCRIPTION

- Base manufactured from phosphated pressed steel, epoxy powder coated with hammered effect finish, guaranteeing long-term resistance to atmospheric agents.
- Aerodynamically contoured inlet port for optimum performance, fashioned as a single unit with the base and gauged to optimize air flow.
- Pressed steel motor cover: pickled and phosphated surface, polyester powder coated and oven baked finish, colour grey, with hammered texture.
- Asynchronous motor with thermal overload cutout and shaft turning in ball bearings, coupled to backward curved impeller with dynamically balanced self-cleaning aluminium blades (UNI ISO 1940, Point 1 – Class

- 6.3).
- Maximum airflow: 750 m<sup>3</sup>/h.
- Protection grille with anti-bird rings (in accordance with UNI ISO 13857 standard), made of electrically welded steel; epoxy paint finish, colour black.
- Sub-frame for fixing the appliance to the flue stack.
- Equipped with steel safety wire for anchoring the appliance once installed.
- Designed for use at a continuous operating temperature of 200 °C.
- Variable speed controller supplied as standard.

### CURVES

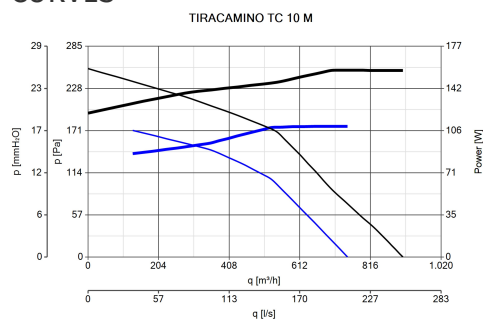

### ACCESSORIES

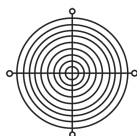

**TR-G 10/15  
(GRIGLIA DI  
PROTEZIONE)**

Code 22700



**KIT SCB  
(TRASF.E.C.)**

Code 22481

#### PER INFORMAZIONI:

**Servizio al Cliente:** tel +39 02 90699395 premendo 1 dopo messaggio registrato (consulenza su prodotti e impianti)

**Pre & Post Vendita:** fax +39 02 90699302

**Email prevendita:** [prevendita@vortice-italy.com](mailto:prevendita@vortice-italy.com)